

MARKER WALL INSTALLATION INSTRUCTIONS

1. Install No. 1015 Ground Sill maintaining 1/4" space above floor (or base board, if already installed). Cut sill 2-1/2" shy of overall width of installation, allowing 1-1/4" on each side. Insert 1/2" blocking. (See Figure 1)
 - 1) Make sure sill is level.
2. Install No. 1015 Ground Jamb starting from either side. Align jamb corner with sill corner. Make sure it is plumb. Note: Jamb must be 1-1/8" longer than panel height.
3. Install No. 1015 Ground Head maintaining 1/4" from ceiling. Cut shy 2-1/2" of overall width and mount inside jamb. Note: Overall opening height must be 1/2" shorter than panel height. (See Figure 1)
4. If wall-to-wall installation, allow 1/8" to 1/4" space so No. 1016 Trim can be snapped into place.
5. Apply egg-size gobs of adhesive to back of first panel, staggered on approximate 2' centers. Install panel by inserting into head trim, swinging bottom of panel over sill trim and setting down onto blocking. Adjust panel sideways to fit inside jamb trim. Compress glue to flush panel face and adjust so open side is plumb.
6. Repeat with additional panels, using chosen joint connection, until all panels are installed. Note: On the last panel, apply adhesive at panel edge to support it when No 1015R Ground Jamb (with back leg ripped off) is screwed into place.
7. After all panels are installed, screw No. 1015R Ground Jamb, with back leg ripped off, through panel into wall. (Note: Over-tightening screws may cause panel to bow.) Cap both jambs with No. 1016 Trim. Note: No. 1016 Trim must be cut 1/4" longer than No. 1015 Jamb. Then, cut No. 1016 Trim for head and sill to fit between jambs. (See Figure 2)

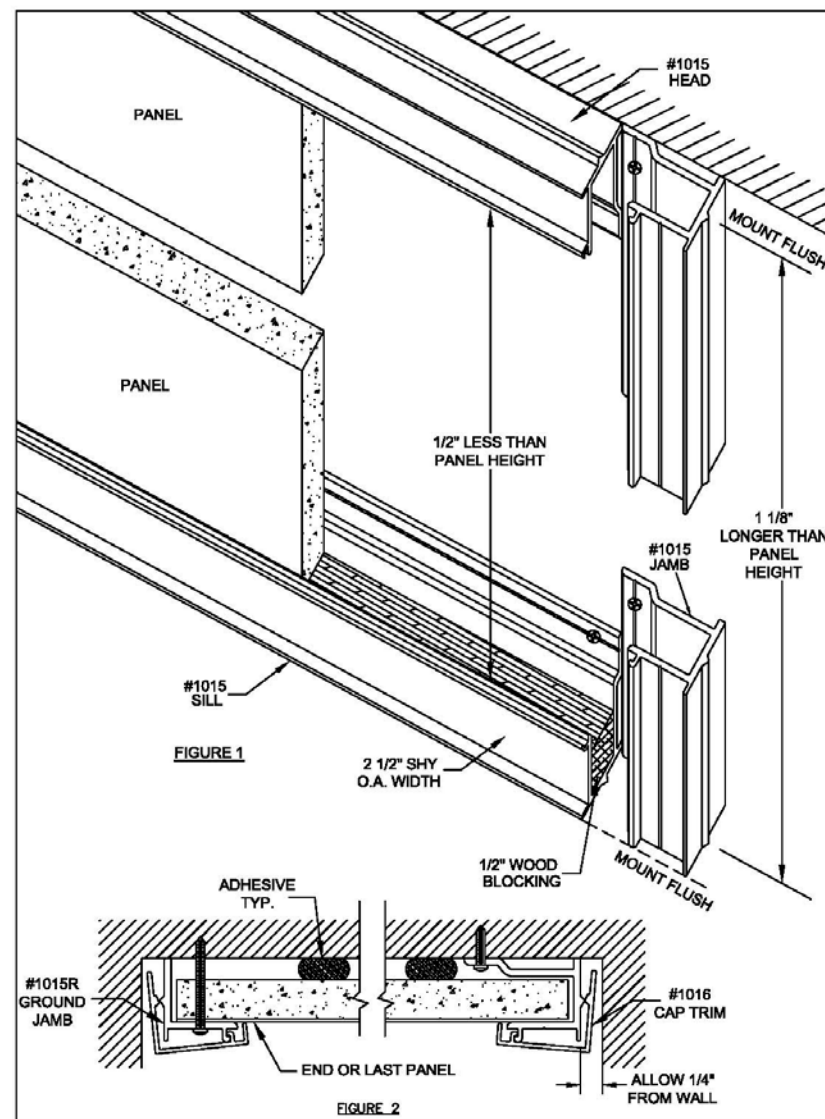

CLARIDGE PRODUCTS AND EQUIPMENT, INC.
P. O. BOX 910
HARRISON, ARKANSAS 72602-0910
PHONE: 870-743-2200
FAX: 870-743-1908
www.connectbyclaridge.com

